

THIS IS A DIRECT PHOTOGRAPHIC REPRODUCTION OF THE OFFICIAL INSTRUMENT (RECORDED PLAT).

THIS REPRODUCTION WAS MADE BY BUCHER & WILLIS CONSULTING ENGINEERS, PLANNERS & ARCHITECTS IN JUNE 1979

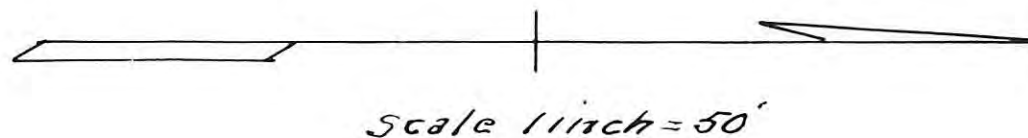

BLOCK 2 BRAUN'S FIRST ADDITON

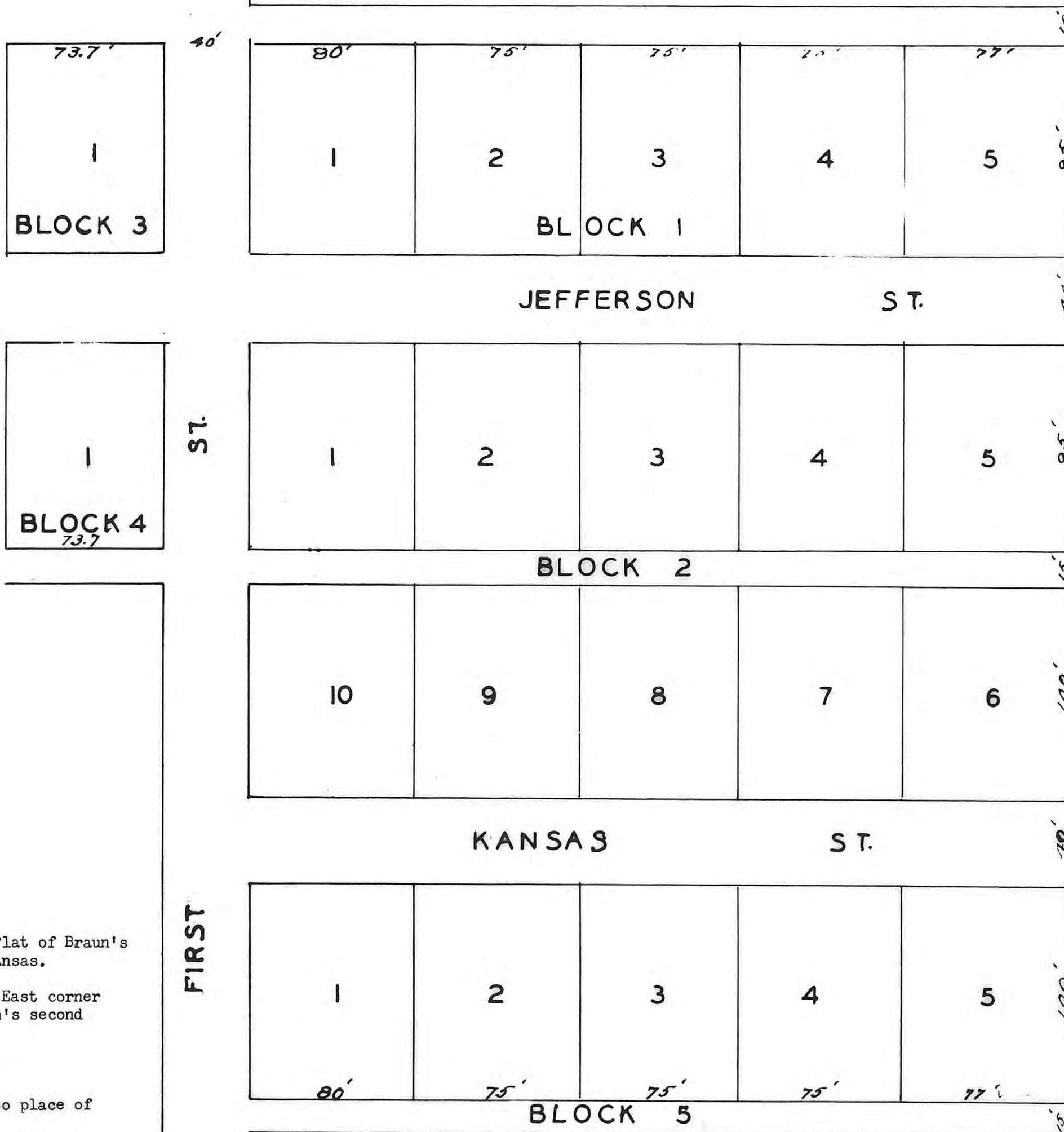

Field Notes for Supplemental Plat of Braun's Second Addition to Victoria Kansas.

Beginning at the North East corner lot 5, block 2 in Braun's second addition to Victoria.
 Thence East 270 feet.
 Thence South 422 feet.
 Thence West 270 feet.
 Thence North 422 feet to place of beginning,

C. J. Lorebitsch
 C. J. Lorebitsch
 County Engineer

STATE OF KANSAS
 ELLIS COUNTY
 This instrument was filed for record

AUG 2 1956

Recorded in
 Book 49 page 49
 Registrar of Deeds

SUPPLEMENTAL PLAT OF BRAUN'S SECOND ADD.
 TO
 VICTORIA KANSAS