

CATHEDRAL HEIGHTS THIRD ADDITION

VICTORIA, KANSAS

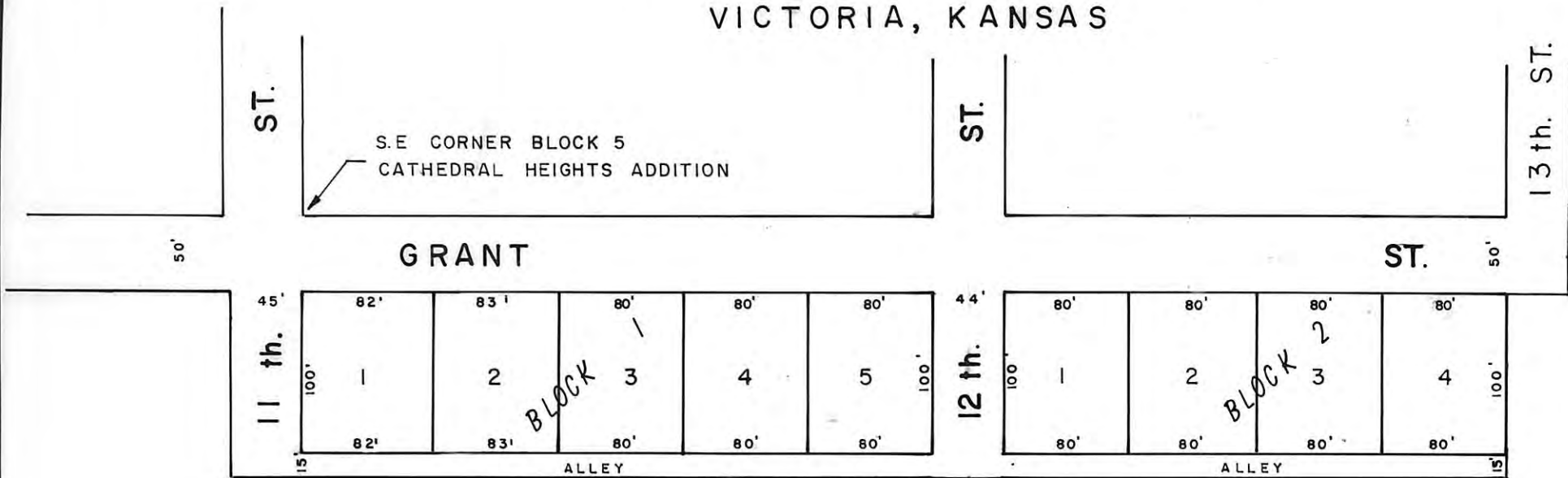

LEGAL DESCRIPTION

Commencing at the Southeast corner of Block 5, Cathedral Heights Addition to the City of Victoria, Kansas; thence east a distance of 50 feet to the point of beginning; thence north along the east line of Grant Street in the City of Victoria, Kansas, a distance of 769 feet; thence east a distance of 115 feet; thence south parallel to the east line of Grant Street a distance of 814 feet; thence west a distance of 115 feet; thence north along the east line of Grant Street 45 feet to the point of beginning.

DEDICATION

We the undersigned owners, of the heretofore described tract, have caused the same to be subdivided into lots and blocks as shown on the plat above. The streets and alleys are dedicated to the public for street and utility purposes.

Anthony Bollig
Anthony Bollig

Euphrosine Bollig
Euphrosine Bollig

Robert L. Schmidtberger
Robert L. Schmidtberger

Marie Schmidtberger
Marie Schmidtberger

SURVEYOR'S CERTIFICATE:

I hereby certify that I have subdivided the heretofore described tract of land and have placed steel pins at the corners. The accompanying plat is a true and correct copy of said subdivision.

NOTARY PUBLIC

State of Kansas ss
County of Ellis

The above dedication was acknowledged by Anthony Bollig and Euphrosine Bollig, his wife, and Robert L. Schmidtberger and Marie Schmidtberger, his wife, this 9th day of September, 1975.

My Commission Expires 22nd March 1978



A. F. Bagall
Notary Public

FILING RECORD: OCT 13 1975

This is to certify that this instrument was filed for record at the Register of Deeds Office, Ellis, Kansas on this 13th day of Oct., 1975.

\$10.00 : Book 29 page 17.

Virginia Hermyaga
Register of Deeds

Annexation Ordinance
274 O.B.L. page 585



Dud Kirkpatrick Jr.
Surveyor 8-28-75
Date

APPROVED BY:

City Council, City of Victoria, Kansas

9-9-75 Al Rohleder
Date Mayor

Attest: Cora Lou Ryan
City Clerk