

AN ORDINANCE ORDERING THE VACATION OF A CERTAIN ALLEY LOCATED BETWEEN LOT 1, BLOCK 1 OF THE ORIGINAL TOWN OF ELLIS, AND LOT 1, BLOCK 1 OF THE UNION PACIFIC RESERVE ADDITION TO THE CITY OF ELLIS, KANSAS, AND LOT 1, BLOCK 1 OF THE ORIGINAL TOWN OF ELLIS, KANSAS, AND LOT 2, BLOCK 1 OF THE ORIGINAL TOWN OF ELLIS, AND LOT 2, BLOCK 1 OF THE UNION PACIFIC RESERVE ADDITION TO THE CITY OF ELLIS, KANSAS

Filed  
No. 1139  
Date 7/20/98  
Clerk

BE IT ORDAINED BY THE GOVERNING BODY OF THE CITY OF ELLIS, KANSAS:

Section 1. The alley in the Original Town of Ellis, Kansas; more specifically described as an alley between Lot 1, Block 1 of the Original Town of Ellis, Kansas, and Lot 1, Block 1 of the Union Pacific Reserve Addition in the City of Ellis, Kansas and between Lot 13, Block 1 of the Original Town of Ellis, Kansas, and Lot 2, Block 1 of the Union Pacific Reserve Addition in the City of Ellis, Kansas; shall be vacated by the City, with the ownership of the above mentioned property reverting to the owners of the real estate adjacent thereto in proportion to the frontage of such real estate.

Section 2. After this ordinance takes effect, a certified copy of the above ordinance shall be filed by the Clerk of the City with the County Clerk and the Register of Deeds of Ellis County, Kansas.

Section 3. This ordinance shall be in full force and effect 30 days after its publication in the Ellis Review, the official city newspaper, unless a written protest is filed by one or more interested parties prior to its effective date. This ordinance shall repeal all conflicting ordinances.

PASSED by the Council and approved by the Mayor on this 20th day of July, 1998.

*David McDaniel*  
DAVID MCDANIEL - MAYOR

STATE OF KANSAS  
ELLIS COUNTY  
This instrument was filed for record

SEP 1 1998  
10:30 AM  
This instrument was recorded in  
the office of the Register of Deeds  
of Ellis County, Kansas  
Fees \$2.00  
Register of Deeds

BOOK 455 PAGE 217

# ELLIS

## ELLIS COUNTY

### KANSAS

Location

East 87 1/2 Acres of N.E. 1/4 Sec. 8 T.13S.R.20W.

Scale, One Inch to 150 feet

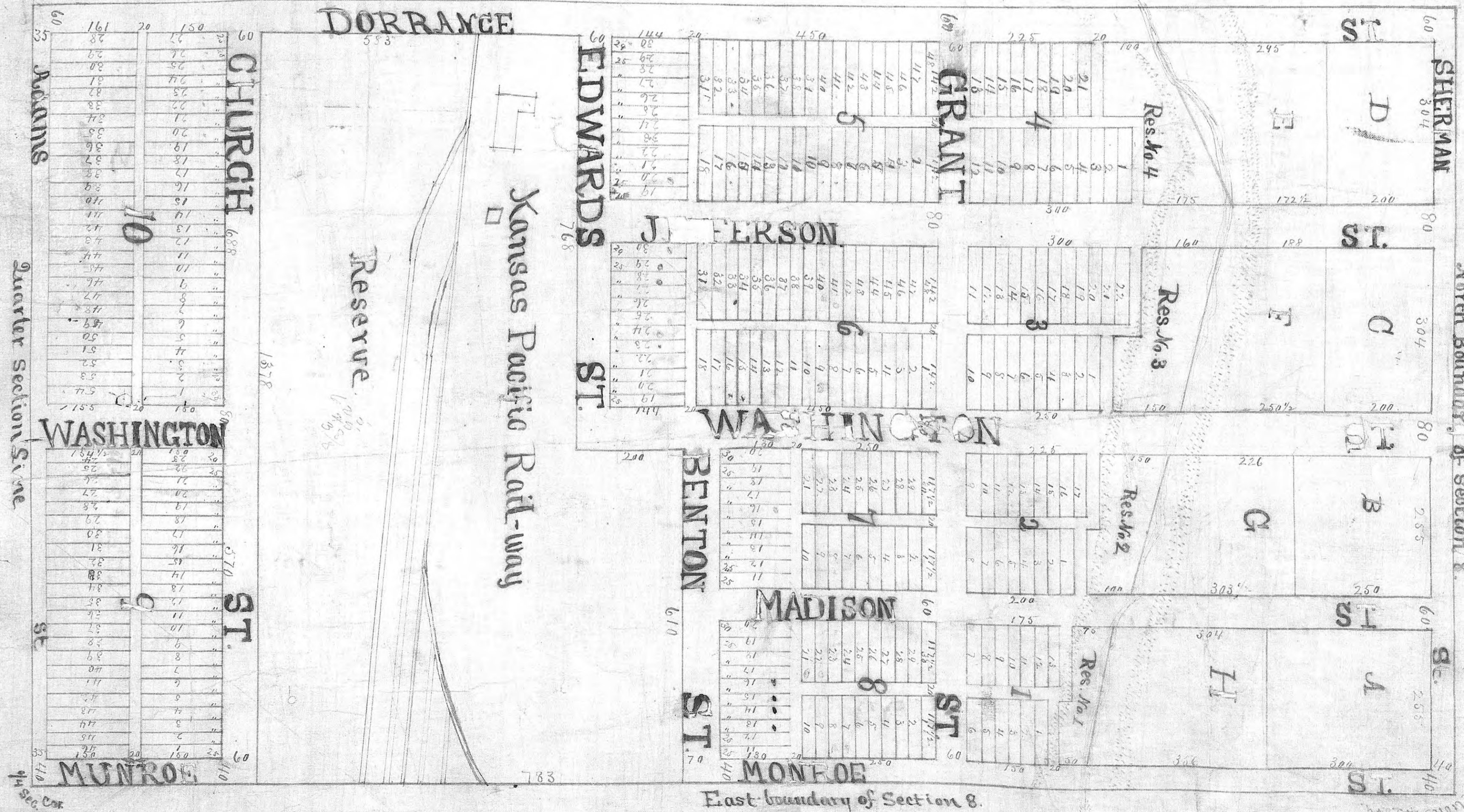

North Boundary of Section 8.

East boundary of Section 8.

Corrected Sections 4, 5, 6, 7, 8, 9, 10, 11, 12, 13, 14, 15, 16, 17, 18, 19, 20