

Pleasant View.

Subdivision of
Lot 40 Lebold Allen & Co Addition.

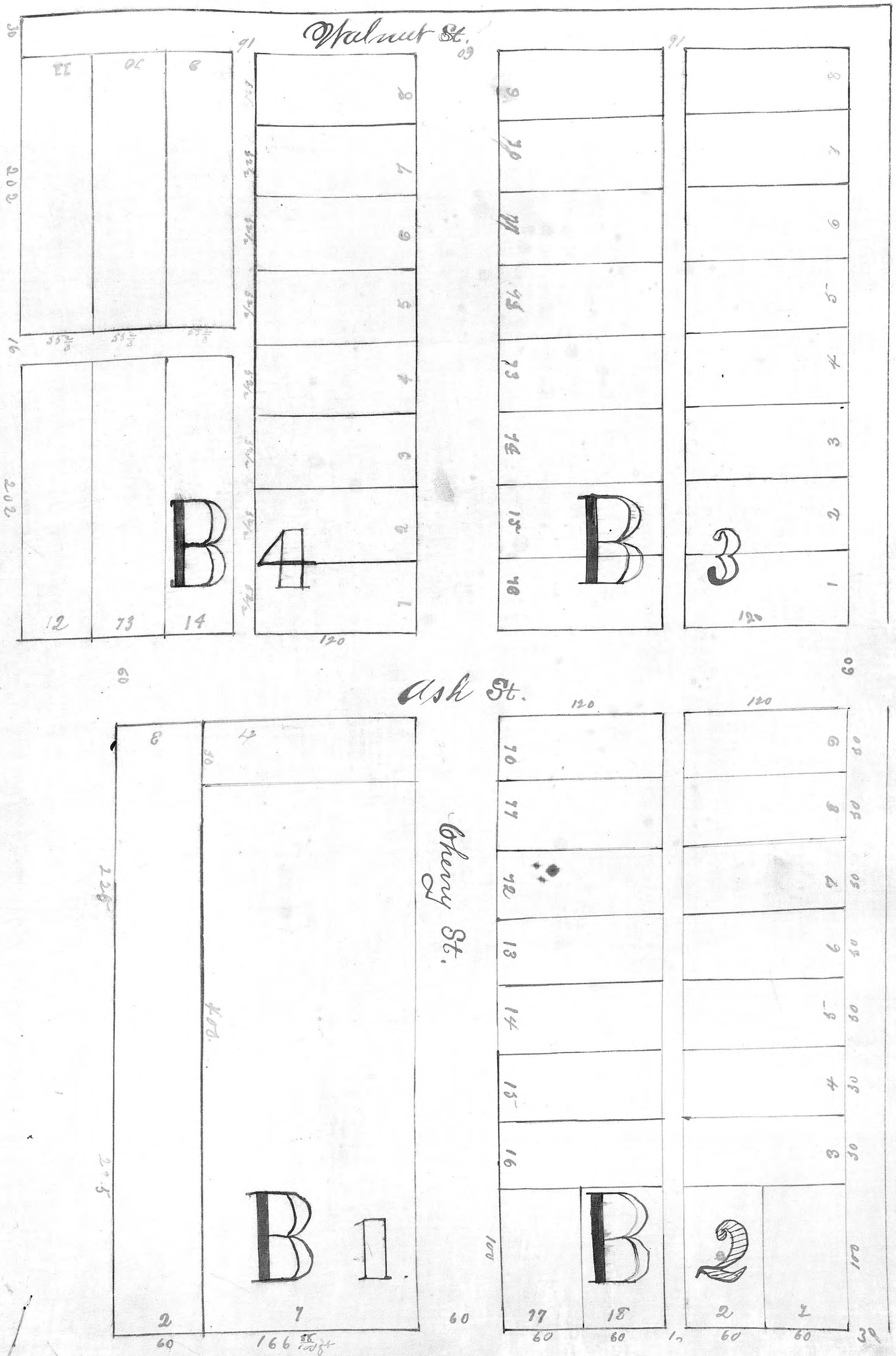

I hereby certify that the foregoing is a true and correct plat of Pleasant View subdivision of Lot 40 Lebold Allen & Co's addition to Hays City as surveyed by me. The streets and alleys and dimensions of the lots are indicated by figures in the margin.
Witness my hand this 9th day of April A. D. 1887
Nathaniel Robbins
Surveyor.

Cancelled by Order.
see Page 307 of Deed Record #6
P. J. Rome, Register

Filed for record this 11th day of April A. D. 1887
Eli E. Fox Register Deeds
By Will A. Robbins
Dep'y